

INFORMATION  
MINIMUM FALL ZONE  
SURFACED WITH  
RESILIENT MATERIAL  
AREA

2529 SQ.FT.

PERIMETER

370 FT.

STRUCTURE SIZE

70' 0" x 55' 7"

STRUCTURE IS DESIGNED  
FOR CHILDREN AGES:

- 6-23 MONTH OLDS
- 2-5 YEAR OLDS
- 5-12 YEAR OLDS
- 13 + YEAR OLDS



Registered  
to ISO 9001

Registered  
to ISO 14001



To verify product certification,  
visit [www.ipema.org](http://www.ipema.org)

The play components identified  
in this plan are IPEMA  
certified. The use and layout of  
these components conform to the  
requirements of ASTM F1487.  
To verify product certification,  
visit [www.ipema.org](http://www.ipema.org)

The space requirements shown  
here are to ASTM standards.  
Requirements for other standards  
may be different.

The use and layout of play  
components identified in this plan  
conform to the CPSC guidelines.  
U.S. CPSC recommends the  
separation of age groups in  
playground layouts.

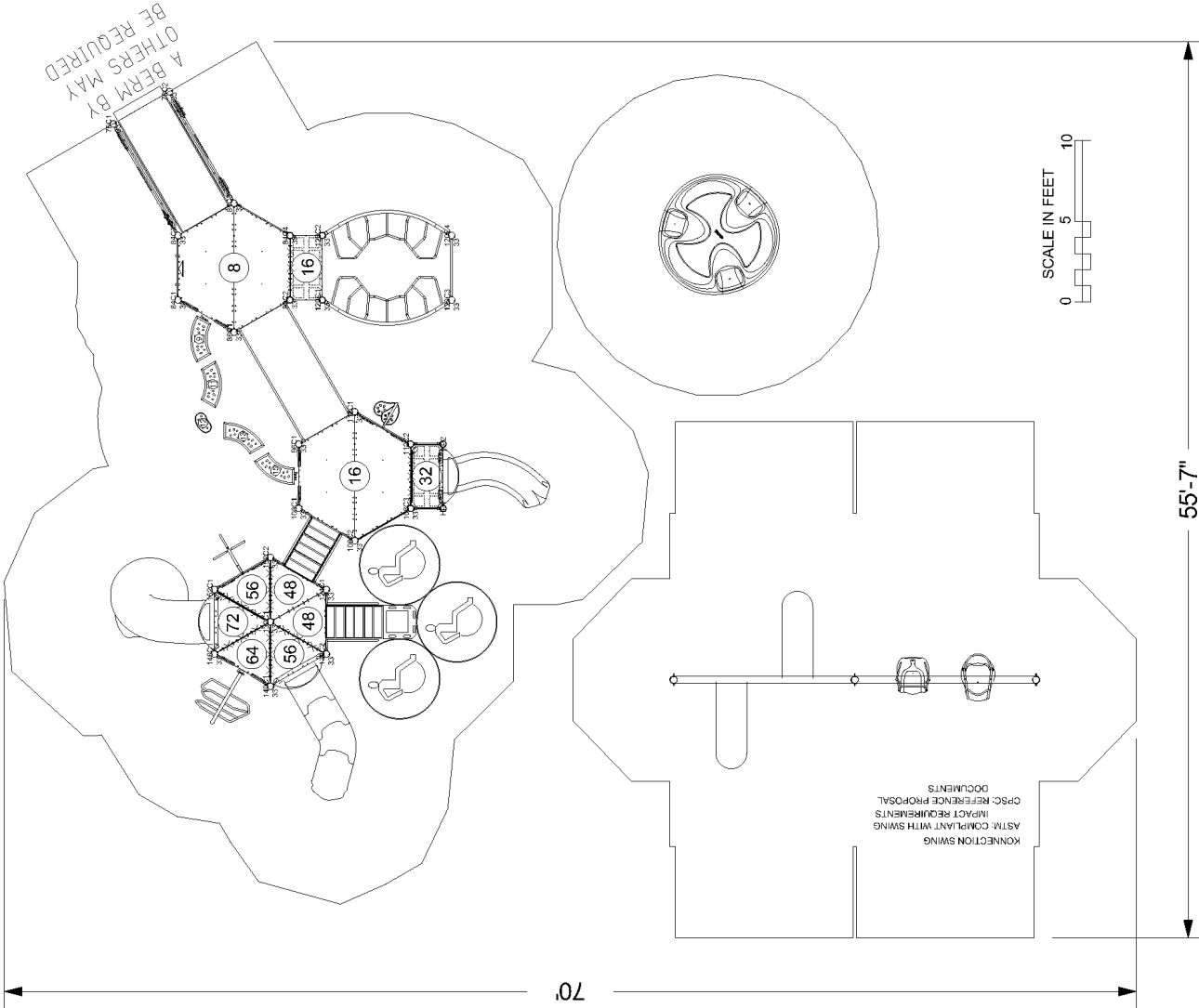

ADA ACCESSIBILITY GUIDELINE (ADAAG CONFORMANCE)

NUMBER OF PLAY EVENTS:	24
NUMBER OF ELEVATED PLAY EVENTS:	10
NUMBER OF ELEVATED PLAY EVENTS ACCESSIBLE BY RAMP:	PROVIDED: 4
NUMBER OF ELEVATED PLAY EVENTS ACCESSIBLE BY TRANSFER SYSTEM:	PROVIDED: 13
NUMBER OF ELEVATED PLAY EVENTS ACCESSIBLE BY RAMP OR TRANSFER SYSTEM:	PROVIDED: 14
NUMBER OF GROUND LEVEL PLAY EVENTS:	PROVIDED: 4
NUMBER OF TYPES OF GROUND LEVEL PLAY EVENTS:	PROVIDED: 3

WARNING!

ACCESSIBLE SAFETY SURFACING MATERIAL IS REQUIRED BENEATH  
AND AROUND THIS EQUIPMENT.  
FOR SLIDE FALL ZONE SURFACING AREA SEE CPSC's Handbook for  
Public Playground Safety.  
PLATFORM HEIGHTS ARE IN INCHES ABOVE RESILIENT MATERIAL.



October 25, 2022

SERIES: Basics, Intensity, Nucleus

Lamar Park - Milton

Lee Recreation, LLC

SITE PLAN

710 Janesville St

142-160747-1

DRAWN BY: Kay Garcia

Milton, WI 53563

ITEM	COMP	DESCRIPTION
1	270-0008	8" CLOSURE PLATE, ELLIPSE
2	270-0120	EVOLUTION UNITARY ENCLOSURE
3	270-0121	EVOLUTION STANCHION
4	270-0125	SENSORY RAIL 8" RISE ENTRANCE
5	270-0129	TRIANGLE PLATFORM
6	270-0131	HEXAGONAL PLATFORM S5P
7	270-0221	8" RISE RAMP W/ GUARDRAILS
8	270-0290	HALF PLATFORM
9	270-0291	HALF PLATFORM W/SUPPORT
10	270-0300	ABSTRACT PLATFORM LADDER
11	370-0016	GRAB BAR ASSEMBLY
12	370-0040	EVOLUTION 32" TRANSITION ST
13	370-0093	LINKING RING CLIMBER 56"-72"
14	370-0247	END RUNGS
15	370-1641	VERVE XS CLIMBER 64" DK
16	370-1662	TRANSFER STATION, BARRIER 4
17	370-1670	PETAL STEP CLIMBER 16"-24"
18	370-1684	ROUND-A-BOUT, NUCLEUS
19	470-0661	VIPER R 48-56 W/O HOOD
20	470-0802	MONACO SLIDE, 32"-40"
21	470-0804	SLIDE HOOD, LOW SIDE WALL
22	470-0805	SLIDE HOOD, HIGH SIDE WALL
23	470-0872	EXTREME TWIST SPIRAL SLIDE
24	550-0112	BELT SEAT, 8" PAIR, STD CHAIN
25	550-0171	FREEDOM SWING SEAT, 8" BEAM
26	550-0191	CONNECTION SWING
27	550-0201	SINGLE POST SWING ASSEMBLY
28	550-0202	SINGLE POST SWING ADD-ON 5'
29	560-2579	VOLTA INCLUSIVE SPINNER
30	570-0105	SENSORY RAIL MIDDLE PANEL
31	570-0116	HYPNO SENSORY EVENT, LOWE
32	570-0117	MELODY SENSORY EVENT, TOP
33	570-0120	RAINDROPS SENSORY EVENT, T
34	570-0125	GROOVY SENSORY EVENT, LOW
35	570-0622	PLATFORM ROLL GUARD
36	570-2624	HALF PIPE WALL
37	570-2667	BEE ACCESSIBLE REACH PANEL
38	570-2668	CAR ACCESSIBLE REACH PANEL
39	570-2669	MAZE ACCESSIBLE REACH PANE
40	580-1312	NOVO ARC BENCH
41	580-1364	LIL NOVO BEAN STEP

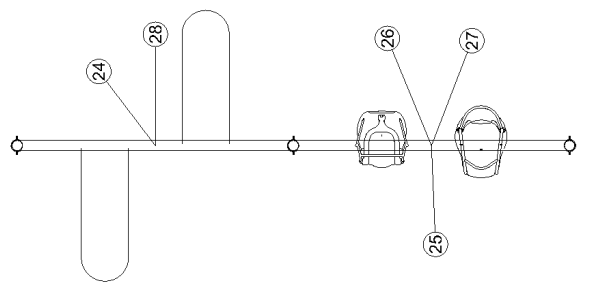
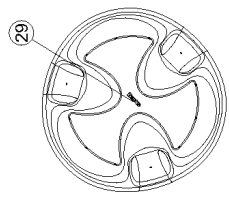
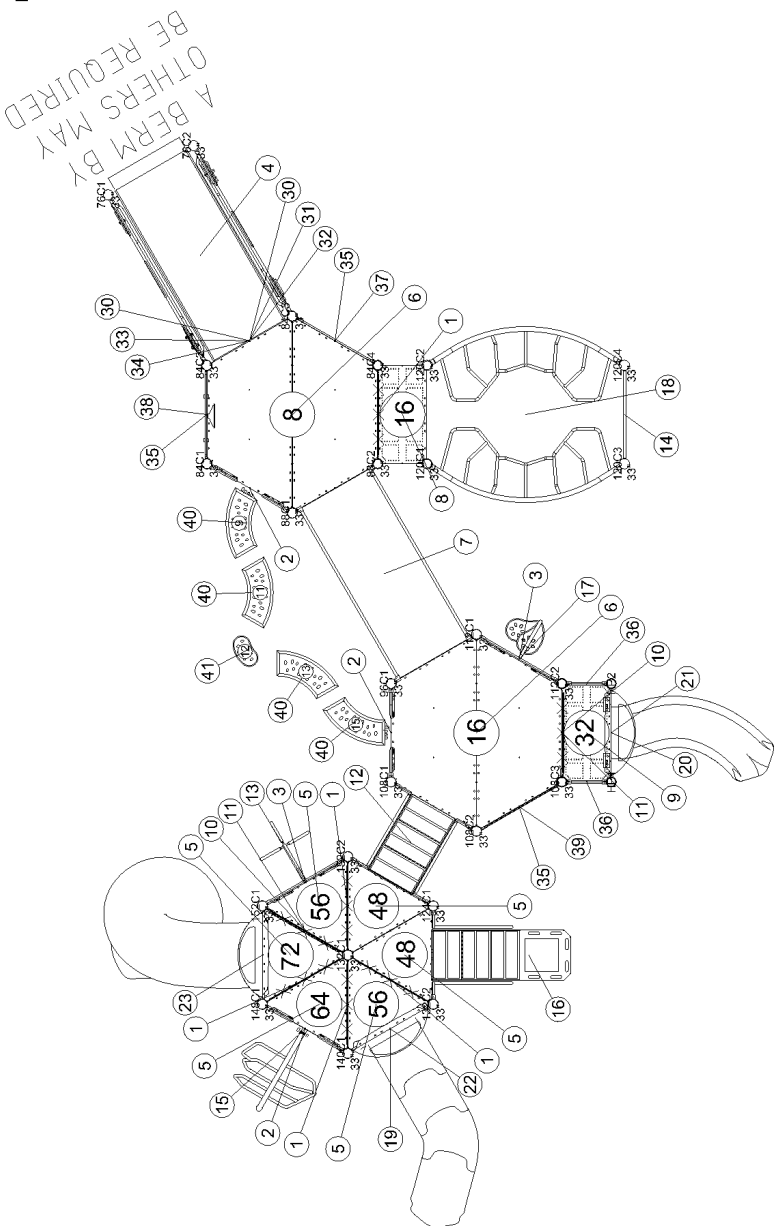

KONNECTION SWING  
 ASTM: COMPLIANT WITH SWING  
 IMPACT REQUIREMENTS  
 CPSC: REFERENCE PROPOSAL  
 DOCUMENTS



October 25, 2022

SERIES: Basics, Intensity, Nucleus  
 COMPONENT PLAN  
 DRAWN BY: Kay Garcia

Lamar Park - Milton  
 710 Janesville St  
 Milton, WI 53563

Lee Recreation, LLC  
 142-160747-1